

TIP OF THE WEEK

MODEL	WA270-8, WA320-8
FEATURE	NEW VSC/K-TCS DECALS
STD / OPT	Standard

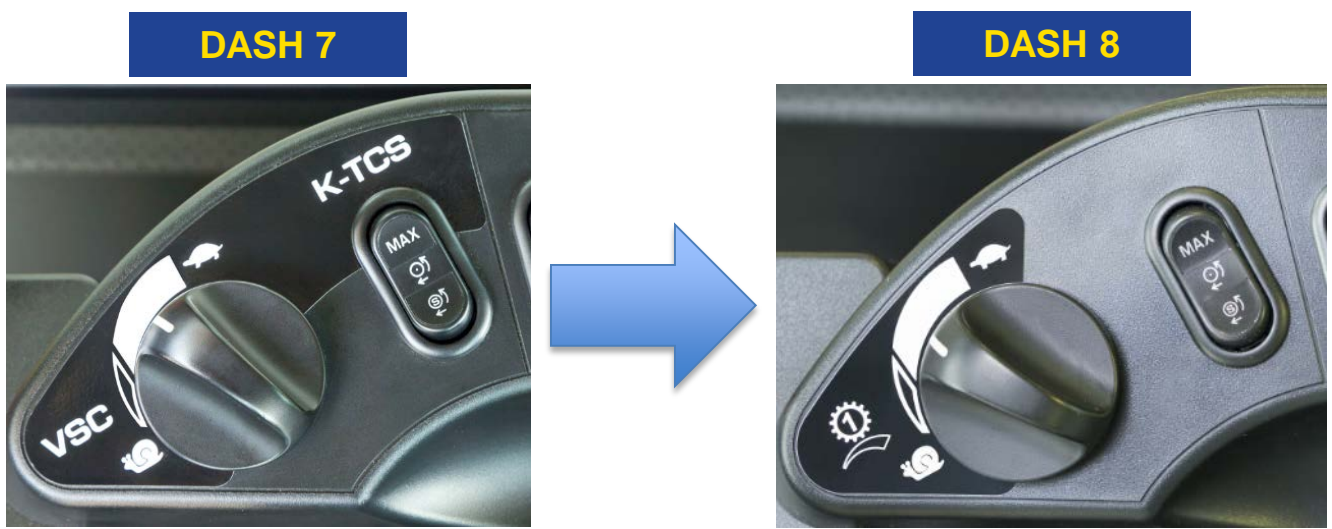

The WA270-8 and WA320-8 hydrostatic wheel loaders feature new, simplified transmission decals while maintaining the same functionality as their predecessors.

Variable speed control, with creep mode, activates when the operator has the machine in 1st speed range. This is done by selecting the speed range with the barrel adjuster on the left side of the steering column.

Variable speed control allows the operator to limit forward travel speed between 0.6 and 8.0 mph (1-13 kph) while in 1st speed range.

Komatsu Traction Control System has three (3) settings: S-Mode, ON, and MAX. S-Mode is used in slippery or snowy conditions. It is recommended that ON is used in most working conditions. MAX provides full tractive effort, which is useful for digging but can consume more fuel or increase tire wear.

Traction control can be left in the ON position because MAX is available by pushing the ‘trigger’ button on the Multi-function Mono lever when maximum tractive effort is needed, for example when digging in a pile.

For additional information, please consult the Product Bulletin, Operator’s Manual or Shop Manual. Photos may include optional equipment.

